

Num. parte	Materiale	Peso	A°	R	Hr	Hv
PS-1035	1.7225 (42CrMo4)	18.275	60°	0,8	145	145,80

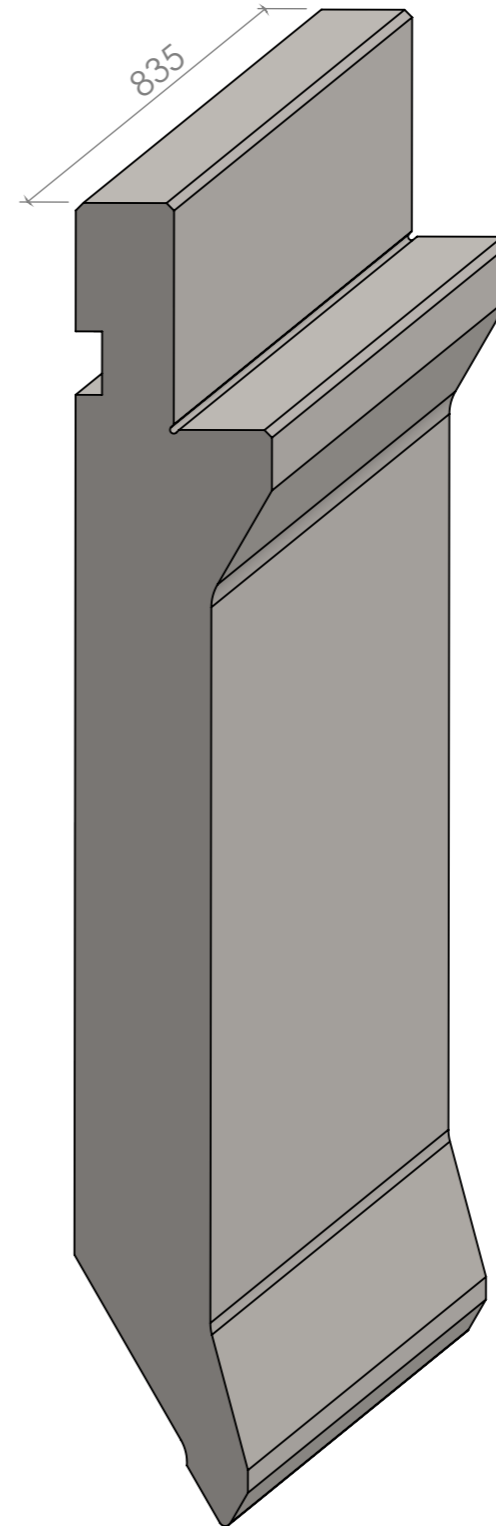
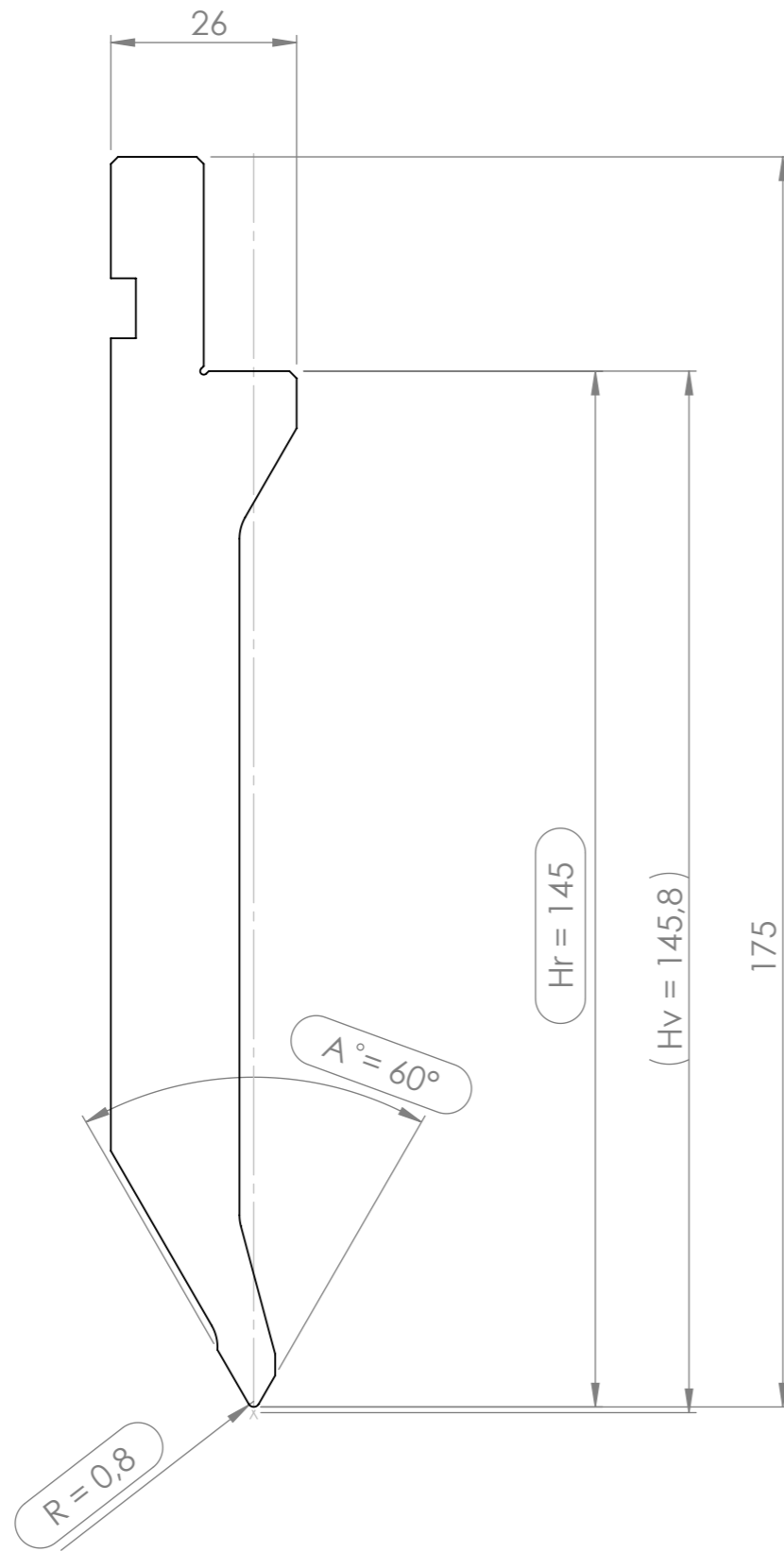

CARICO MAX: 800 kN/m

TRATTAMENTO TERMICO
Temprato a Induzione HRC 52-58

PUNZONE SERIE PS 1035